



CORPORATE  
REALTY GROUP INC.

903, 10050-112 Street  
EDMONTON, ALBERTA  
CANADA T5K 2J1  
PHONE: (780) 428-1799  
FAX: (780) 424-8502  
EMAIL:  
info@crgeadm.com

# ***NEW RETAIL SPACE FOR LEASE***

## **Centennial Plaza, St. Paul**



### **Features:**

- Strategically located in the east commercial corridor of St. Paul, the Centennial Plaza serves a residential and acreage community with a primary trade area estimated at 25,000 people.
- Anchor tenants include a 32,000 square foot Sobeys Food Store, a 42,000 square foot Canadian Tire Store, 25,000 square foot Medical Centre and a 9,000 square foot Drug Store (under construction).
- Another 20,000 square feet of Retail Tenancy deals have been done and will open in the Fall of 2013 and Spring of 2014.

*For Lease*

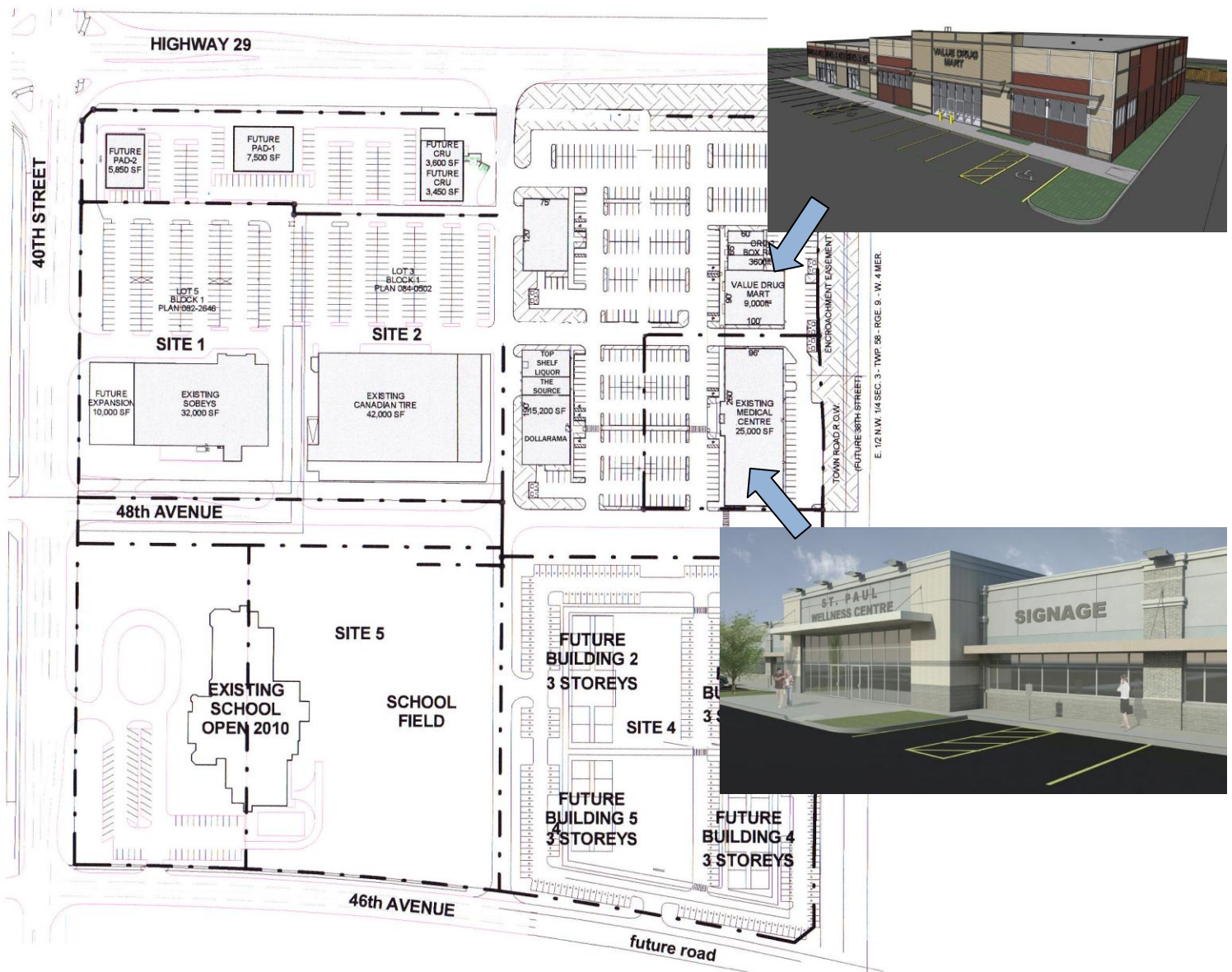

**Summary:**

The Centennial Plaza, St. Paul offers a strong location for future retail tenancy. The Population (2012 Census) of the Town of St. Paul is 5,844 with an estimated trade area of approximately 35,000 people within a 50 kilometre radius.

The Medical Clinic of 25,000 square feet is the major clinic for central/east Alberta and has an average of 400 patient visits per day. The existing Tenancy and future tenancy to come has and will continue to make this Centre the major shopping destination for this region.

Although the above information is from sources believed reliable, no warranty or representation is made as to its accuracy, being subject to errors, omissions, or other changes, and same should not be relied upon without independent verification. This offering is subject to prior sale or withdrawal at any time without notice.

**Contact Information:**

Doug Hobson	Corporate Realty Group Inc.	780-428-1799, ext. 232
dwh@crgedm.com		780-970-0987 (cell)